



Product Details

SQB/SQB-A/-SS/-ASS Loadcell

SQB/SQB-A/-SS/-ASS



平台秤、配料控制系统
Platform scales, blending scale

SQB/SQB-A 0.25-2.5t

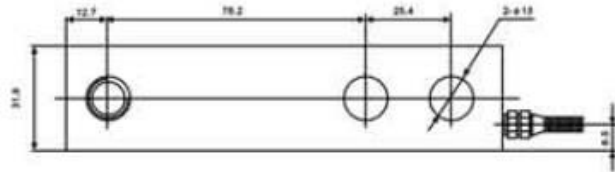
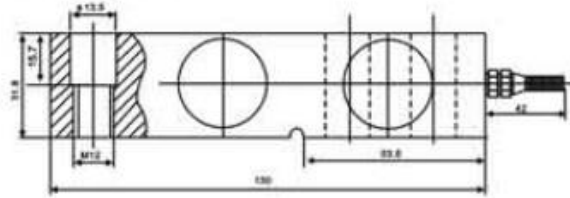

SQB-SS/SQS-ASS 0.25-2.5T

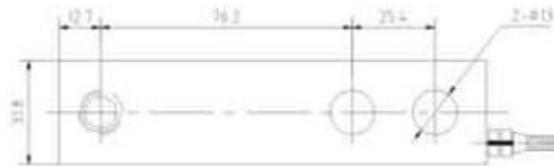
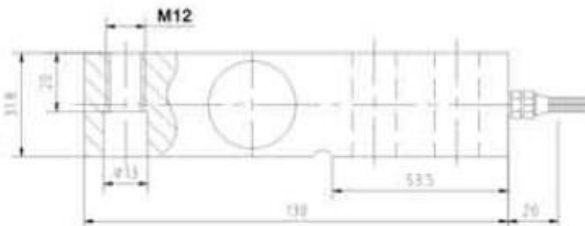

SQB-SS/SQS-ASS 3-10t

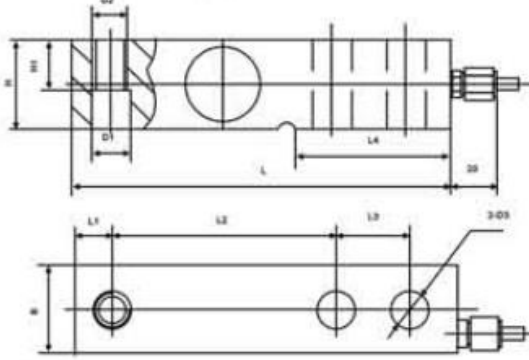

额定载荷(t) Rated Load	L	L1	L2	L3	L4	H8	H1	D1	Ø2	Ø3
3.5	171.5	10	95.3	38.1	72.5	38.1	26	ø20	M18x1.5	ø20
7.5-10	225.5	25.3	124	50.8	102	50.8	25.4	ø27	M24x2	ø27

TECHNICAL PARAMETER

额定载荷 Rated capacities(Emax)	0.25, 0.3, 0.5, 0.75, 1, 1.5, 2.2, 5, 3, 5, 7.5, 10t	温度补偿范围 Temperature range, compensated	-10℃~+40℃
灵敏度 Sensitivity	3.0±0.003mV/V(0.5-10t); 2.0±0.002mV/V(0.25-0.3t)	工作温度范围 Temperature range, operating	-30~+70℃
精度等级 Accuracy class	C2-C5	安全过载 Maximum safe overload	150%F.S
零点平衡 Zero balance	±1%F.S	极限过载 Ultimate overload	180%F.S
零点温度影响 TCO	±0.02%F.S/10℃	推荐激励电压 Excitation, recommend	10-12V DC
输出温度影响 TC SPAN	±0.02%F.S/10℃	最大激励电压 Excitation, maximum	15V DC
输入阻抗 Input impedance	400±20Ω	防护等级 Protection class	IP67(0.25-0.75t); IP68(1-10t)
输出阻抗 Output impedance	352±3Ω	材质 Construction	合金钢 Alloy Steel 不锈钢 Stainless Steel
绝缘电阻 Insulation impedance	≥5000MΩ	电偶 Cable Length:	3m(0.25-2.5t), 4.2m(3-5t), 5m(7.5-10t)
		Diameter:	φ 5mm(合金钢0.25-5t, 不锈钢0.25-0.3t); φ 6mm(合金钢7.5-10t, 不锈钢0.5-10t)